

0206-002-002  
0206-002-312

1/6

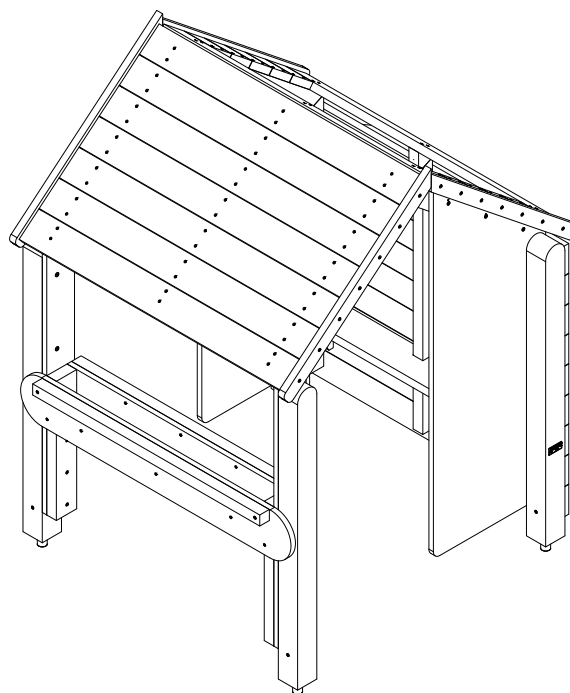

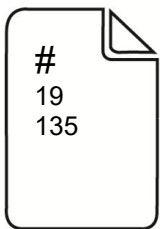
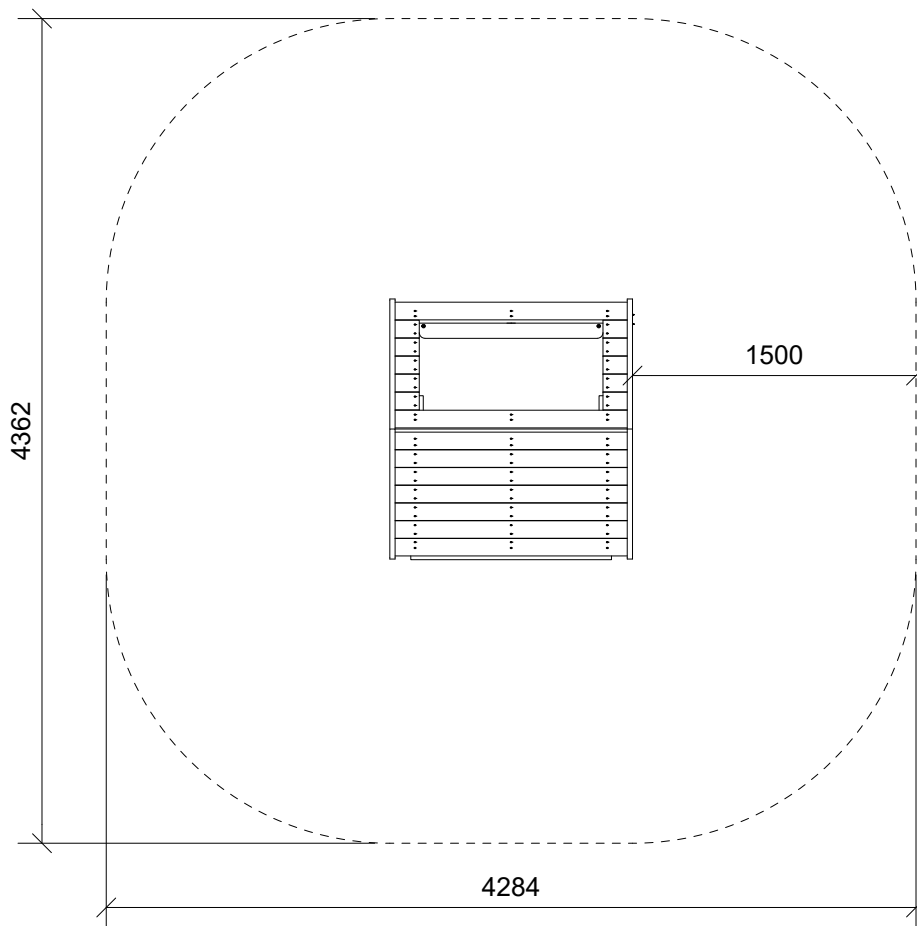
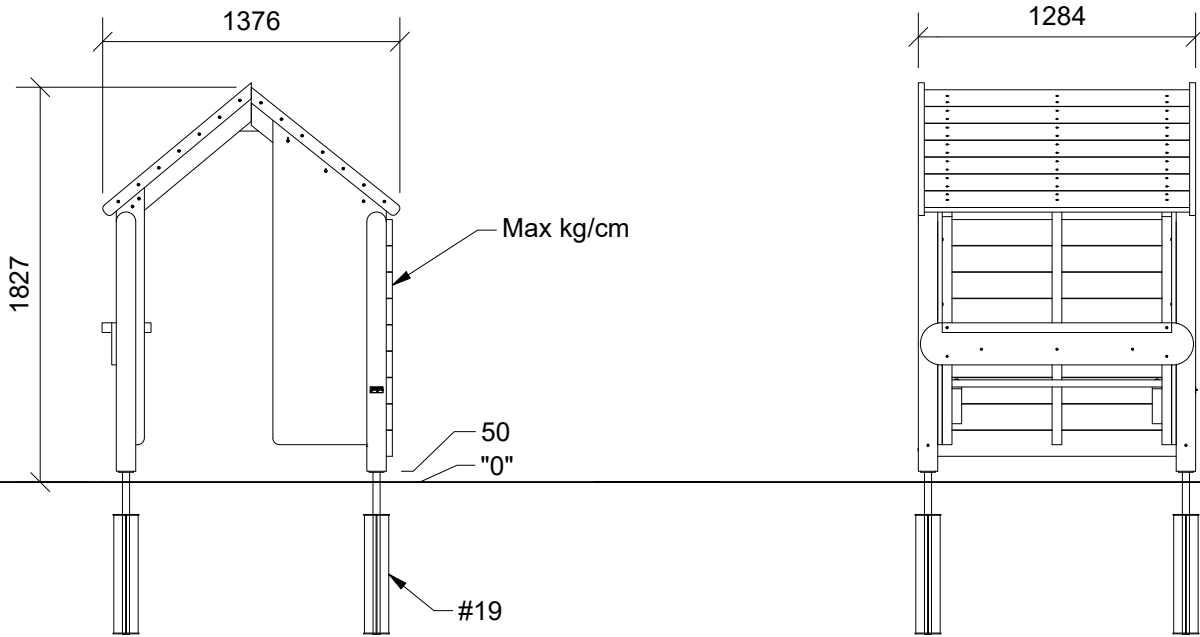

2



1h



4,4 x 4,3 x 1,9 m



~N/A



~0,15 m<sup>3</sup>



127x12x116 cm



30 kg

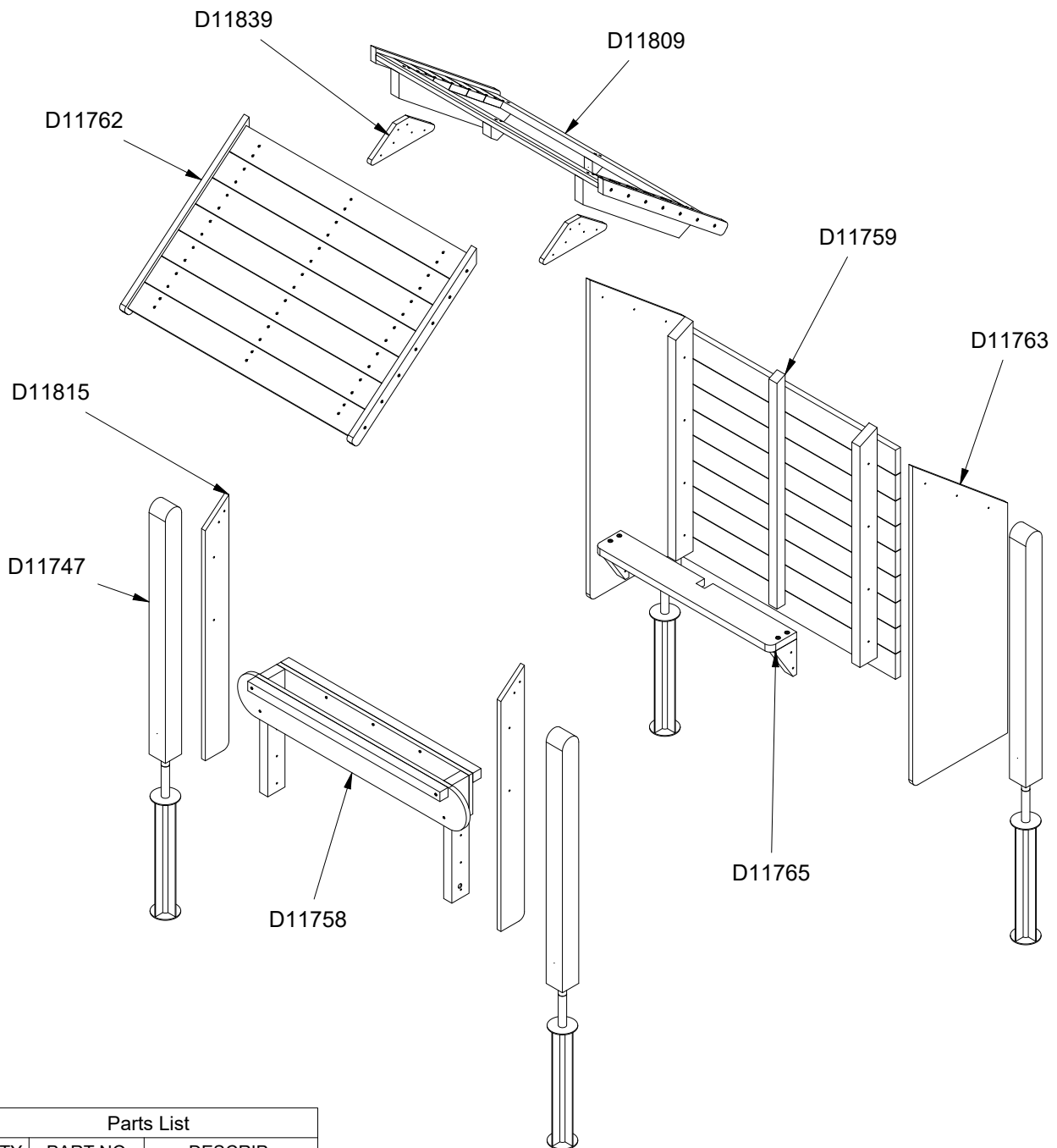

Parts List

| QTY | PART NO | DESCRIP.     |
|-----|---------|--------------|
| 4   | D11747  | 90x90x1200mm |
| 1   | D11758  | Wall         |
| 1   | D11759  | Wall         |
| 1   | D11762  | Roof         |
| 2   | D11763  | Wall, 525mm  |
| 1   | D11765  | Bench        |
| 1   | D11809  | Roof         |
| 2   | D11815  | Wall Part 1  |
| 2   | D11839  | Roof Part    |

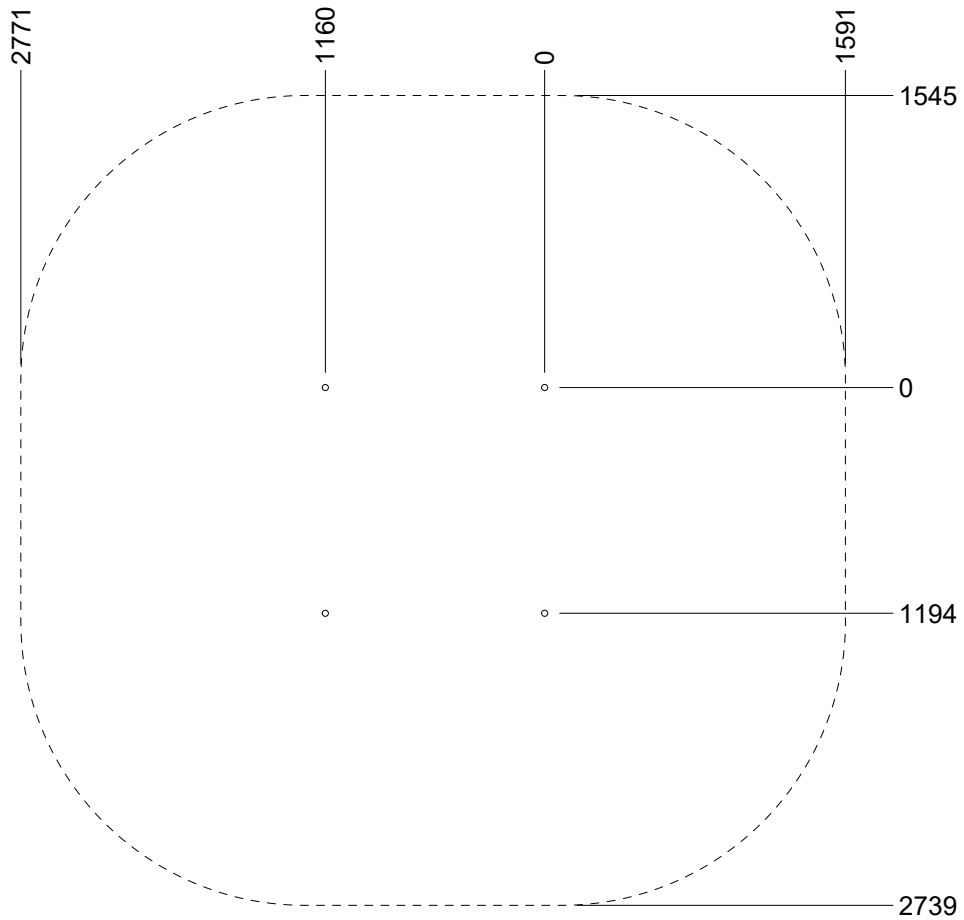
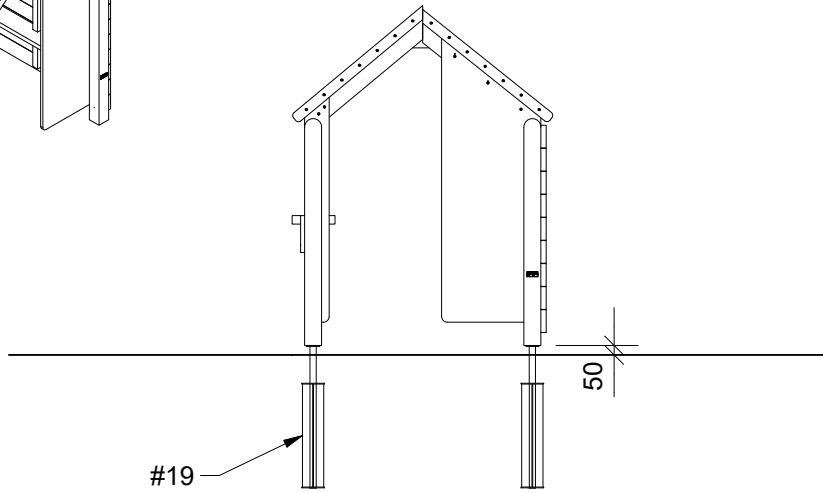
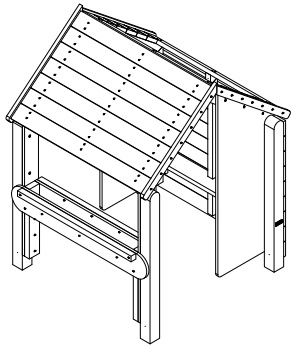

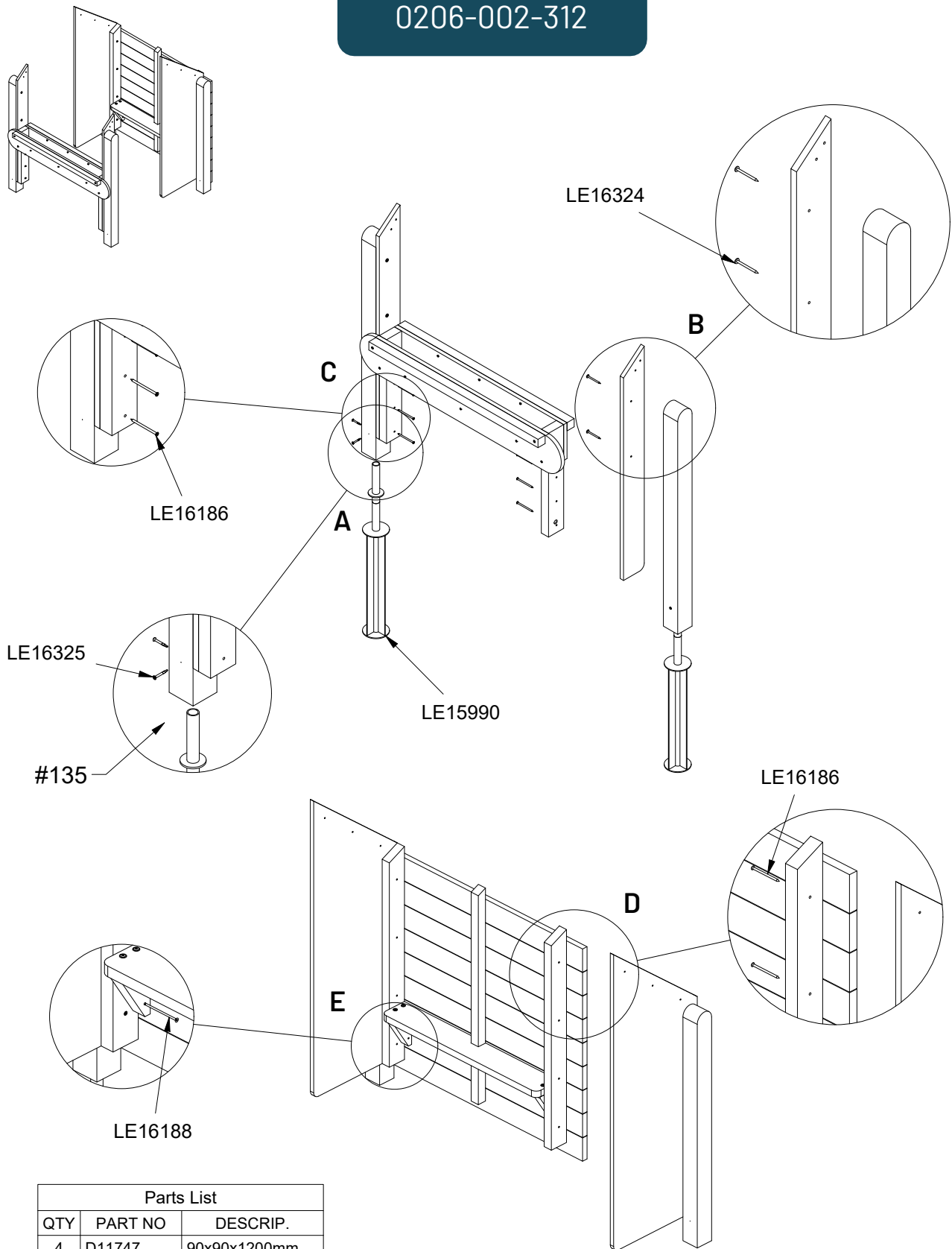

| Parts List |         |              |
|------------|---------|--------------|
| QTY        | PART NO | DESCRIP.     |
| 4          | D11747  | 90x90x1200mm |
| 1          | D11758  | Wall         |
| 1          | D11759  | Wall         |
| 2          | D11763  | Wall, 525mm  |
| 1          | D11765  | Bench        |
| 2          | D11815  | Wall Part 1  |
| 4          | LE15990 | Anchor       |
| 14         | LE16186 | 6x100 Ch     |
| 4          | LE16188 | 6x120        |
| 4          | LE16324 | 6x80 Dh      |
| 8          | LE16325 | 5,5x50       |

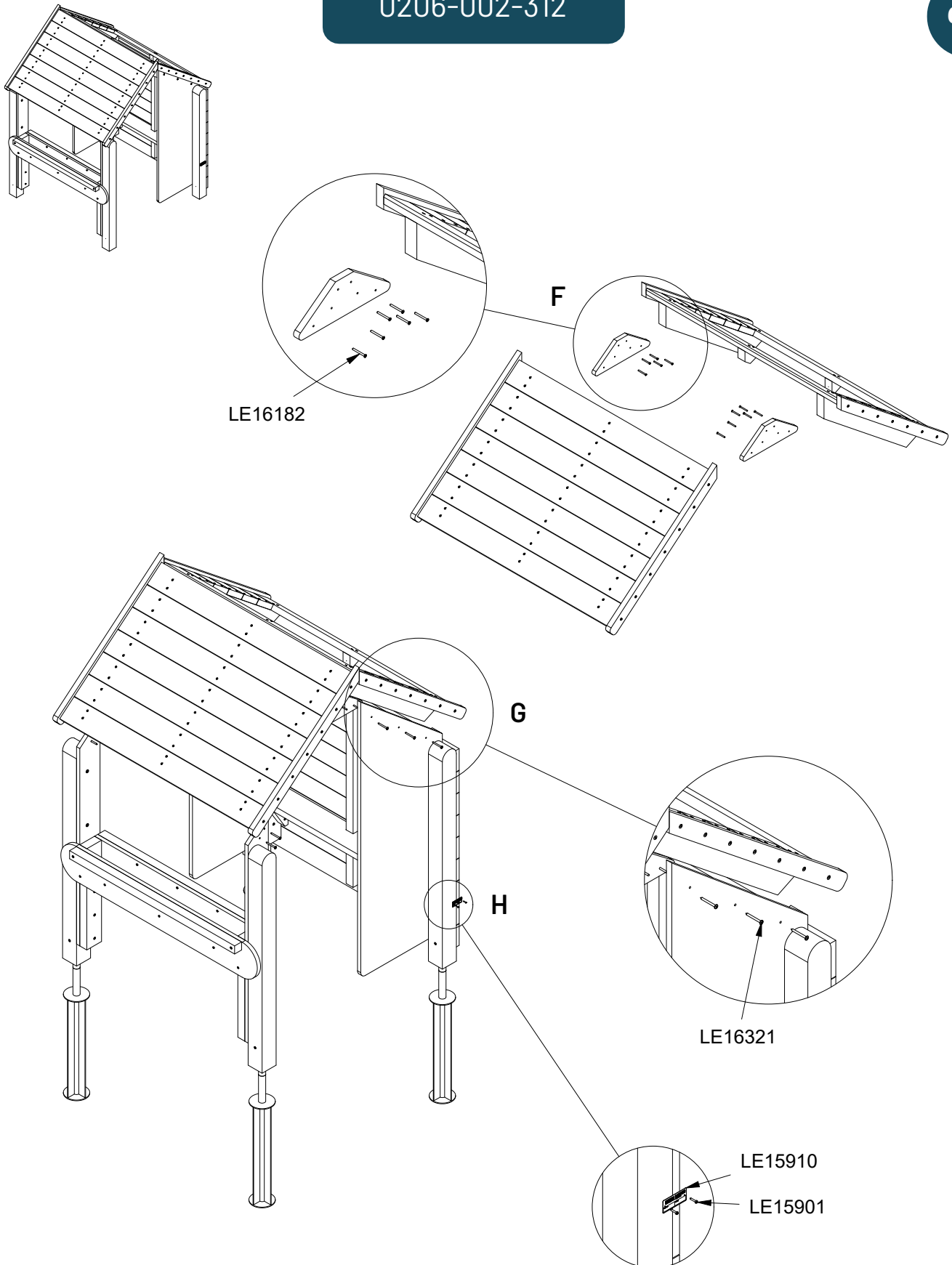

Parts List

| QTY | PART NO | DESCRIP.  |
|-----|---------|-----------|
| 1   | D11762  | Roof      |
| 1   | D11809  | Roof      |
| 2   | D11839  | Roof Part |
| 2   | LE15901 | 3x16, PH  |
| 1   | LE15910 | Name tag  |
| 12  | LE16182 | Ø5x50mm   |
| 10  | LE16321 | 6x60 Dh   |